

8 HOLES ϕ 24
EQUALLY SPACED
ON 600 P. C. D.

CUSTOMER		
ORDER No.		
SERIAL No.		
FRAME SIZE		
kW	RPM.	
Hz	PHASE 3	
VOLTS	POLES	
BRGS.	DE.	NDE.
MOTOR NETT. WT.		Kg.
INSULATION CLASS		
TEMPERATURE RISE	°C	
DESIGN AMBIENT TEMPERATURE	°C	
HEATER WATTS & VOLTS		
WATTS,		VOLTS

REMARKS		

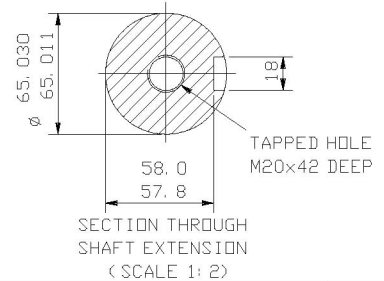

NOTE: -
TERMINAL BOX CAN BE SIDE MOUNTED
(LEFT OR RIGHT) BY REFITTING FEET
90° IN APPROPRIATE DIRECTION.
CABLE ENTRY CAN BE SUPPLIED IN
ANY ONE OF FOUR POSITIONS AT
90° INTERVALS.

ALL DIMENSIONS IN MILLIMETRES



**BROOK
CROMPTON**

NOTE 1 2.5 ENDPLAY WILL BE PROVIDED FOR ENDTHRUST PROTECTION WHEN CUSTOMERS NOTIFY US OF THEIR INTENTION TO USE RIGID COUPLINGS AND DRIVEN MACHINES WITHOUT ENDPLAY.	OUTLINE DIMENSIONS OF STD. FOOT/FLANGE MOUNTED METRIC A. C. MOTOR TOTALLY ENCLOSED FAN VENTILATED. FITTED WITH TOP MOUNTED TERMINAL BOX FRAME SIZE : - W-DF315M-H (2 POLE)	SCALE	1:8	DATE	DRG. No.
		DRAWN			
		CHECKED			
		APPROVED			
		REVISION:		DATE	